



WWW.GOODMANREALESTATE.COM
216.381.8200

FORMER BANK OUTLOT THE SHOPPES AT WILLOUGHBY HILLS

Willoughby Hills, Ohio



HIGHLIGHTS

- Freestanding 4,531 SF bank building with three drive-thru lanes
- Located on Chardon Road in front of the Shoppes at Willoughby Hills
- Nearby retailers and restaurants include NEW Marc's, NEW Aldi, Milestone Athletic Club, Dollar Tree, NEW Zoom Express Car Wash, CVS, Serpentine Chevrolet, McDonald's, Subway, Dunkin', Eastside Volkswagen, NTB, and more

DEMOGRAPHICS

POPULATION	3 MILE	5 MILE	7 MILE
2028 Projection	75,956	187,822	294,163
2023 Estimate	77,455	191,449	299,903
INCOME	3 MILE	5 MILE	7 MILE
2023 Average	\$67,633	\$67,960	\$74,299
2023 Median	\$49,622	\$51,001	\$52,061
DAYTIME POPULATION	3 MILE	5 MILE	7 MILE
2023 Employees	32,002	86,699	127,407

LEASING INFORMATION

www.goodmanrealestate.com
216.381.8200

CLEVELAND

THE OFFICES OF LEGACY VILLAGE
25333 CEDAR ROAD, SUITE 305
CLEVELAND, OH 44124

COLUMBUS

389 E. LIVINGSTON AVENUE
COLUMBUS, OHIO 43215

ZACK SOGOLOFF

Senior Vice President
zack@goodmanrealestate.com

SETH MARKS

Senior Director
seth@goodmanrealestate.com



LEASING INFORMATION

www.goodmanrealestate.com

216.381.8200

ZACK SOGOLOFF

Senior Vice President
zack@goodmanrealestate.com

SETH MARKS

Senior Director
seth@goodmanrealestate.com

FORMER BANK OUTLOT

Willoughby Hills, Ohio



JAN '23



LEASING INFORMATION

www.goodmanrealestate.com

216.381.8200

ZACK SOGOLOFF

Senior Vice President
zack@goodmanrealestate.com

SETH MARKS

Senior Director
seth@goodmanrealestate.com

FORMER BANK OUTLOT

Willoughby Hills, Ohio





LEASING INFORMATION

www.goodmanrealestate.com

216.381.8200

ZACK SOGOLOFF

Senior Vice President
zack@goodmanrealestate.com

SETH MARKS

Senior Director
seth@goodmanrealestate.com

FORMER BANK BUILDING

Willoughby Hills, Ohio



Lease Outline Drawing

Shoppes at Willoughby Hills

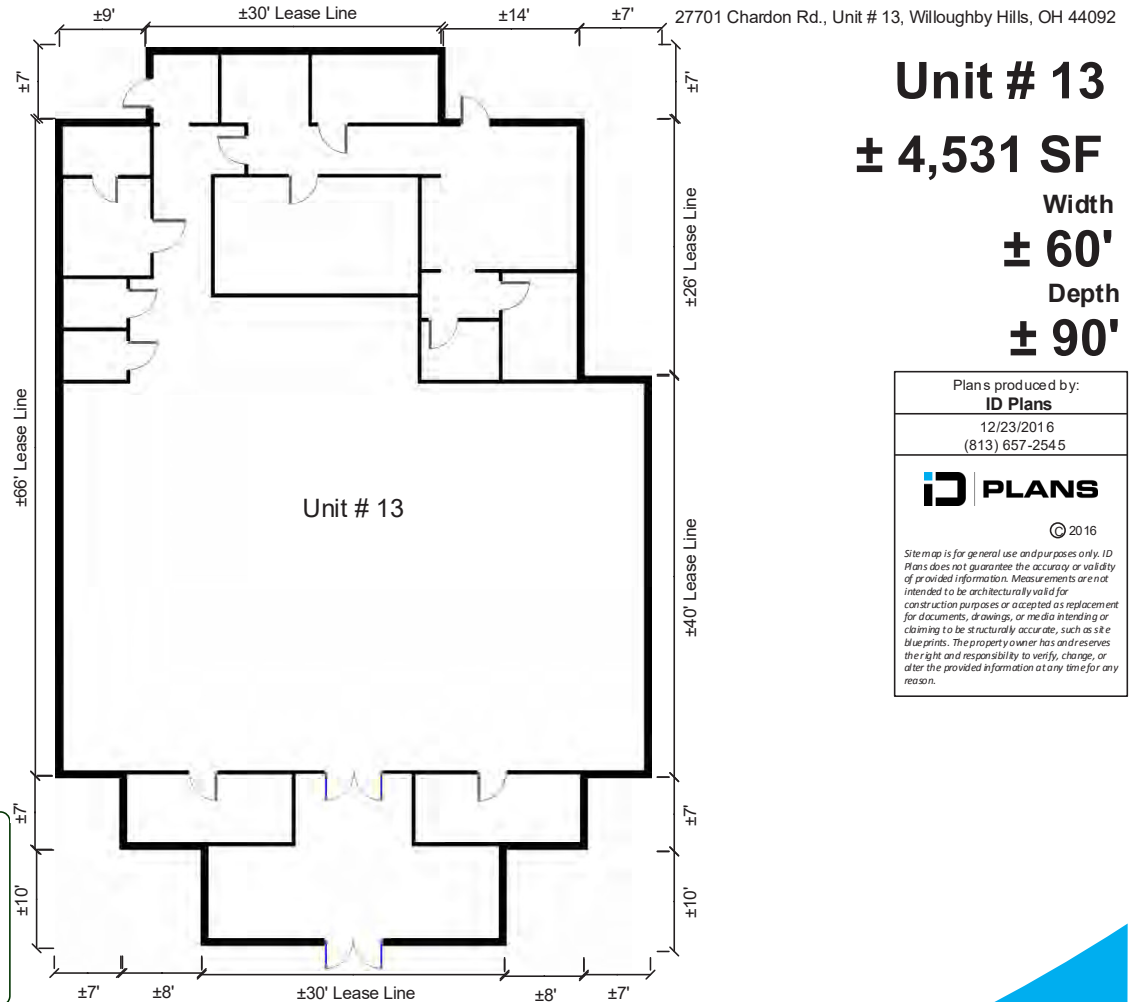

Unit # 13

± 4,531 SF

Width

± 60'

Depth

± 90'

Plans produced by:
ID Plans

12/23/2016
(813) 657-2545



© 2016

Site map is for general use and purposes only. ID Plans does not guarantee the accuracy or validity of provided information. Measurements are not intended to be architecturally valid for construction purposes or accepted as replacement for documents, drawings, or media intended or claiming to be structurally accurate, such as site blueprints. The property owner has and reserves the right and responsibility to verify, change, or alter the provided information at any time for any reason.

	Reference #	Meter #	Size
Electric		A12623189	
Gas		9592526	
Water		69175391	3/4"

HVAC Units & Information

Unit #	Space #	Manufacturer	Model #	Tonnage	Serial #	Year
1	13	TRANE	4TEH3F60B1000AB	5	10214Y251V	2010
2	13	RESCO	FG3AAA060000AAAA	5	4094V17135	1994
3	13	CARRIER	40RR-012---550--	10	1694F92685	1994

Leasing Agent

Email: _____
Office: _____
Cell: _____