



WWW.GOODMANREALESTATE.COM
216.381.8200

THE SHOPS AT HAWK'S LANDING

Jerome Township, Ohio



HIGHLIGHTS

- 10 acres of new, mixed-use land available for development across from Dublin Green Shopping Center (Costco, ALDI, T.J. Maxx, HomeGoods, PetSmart, Sprint, Beer Barrel Pizza & Grill, Bibibop, Chase Bank, Wendy's, and Tim Hortons)
- Over 4,000 new single and multifamily residences in planning and under construction within approximately 3 miles of site
- Excellent visibility from US-33, which carries over 65,000 VPD
- Less than 1 mile from SportsOhio, a 100-acre sports park offering 17 sports/activities, camps, and clinics for both children and adults
- Less than ¼ mile from both Columbus State Community College's Dublin Campus and Ohio University Heritage College of Osteopathic Medicine

DEMOGRAPHICS

POPULATION	3 MILE	5 MILE	7 MILE
2028 Projection	41,568	125,753	247,383
2023 Estimate	38,801	116,820	233,226
INCOME	3 MILE	5 MILE	7 MILE
2023 Average	\$154,976	\$135,948	\$130,317
2023 Median	\$123,360	\$102,845	\$100,346
DAYTIME POPULATION	3 MILE	5 MILE	7 MILE
2023 Employees	27,569	69,624	106,573

LEASING INFORMATION

www.goodmanrealestate.com
216.381.8200

CLEVELAND

THE OFFICES OF LEGACY VILLAGE
25333 CEDAR ROAD, SUITE 305
CLEVELAND, OH 44124

COLUMBUS

389 E. LIVINGSTON AVENUE
COLUMBUS, OHIO 43215

DANIEL CLARK

VP and Manager, Columbus Office
daniel@goodmanrealestate.com

JOE BELINSKE

Sales Associate, Columbus Office
joe@goodmanrealestate.com



LEASING INFORMATION

www.goodmanrealestate.com

216.381.8200

DANIEL CLARK

VP and Manager, Columbus Office

daniel@goodmanrealestate.com

JOE BELINSKE

Sales Associate, Columbus Office

joe@goodmanrealestate.com

THE SHOPS AT HAWK'S LANDING

Jerome Township, Ohio



THE INFORMATION ABOVE HAS BEEN OBTAINED FROM SOURCES BELIEVED TO BE RELIABLE. GOODMAN REAL ESTATE SERVICES GROUP LLC AND ITS AGENTS, ASSOCIATES, AND EMPLOYEES MAKE NO GUARANTEE, WARRANTY OR REPRESENTATION ABOUT IT. ALL IMAGES CONTAINED HEREIN ARE THE PROPERTY OF GOODMAN REAL ESTATE SERVICES GROUP LLC AND SHALL NOT BE DUPLICATED OR REPRODUCED WITHOUT EXPRESS WRITTEN CONSENT OF GOODMAN REAL ESTATE SERVICES GROUP LLC. YOU ACKNOWLEDGE THAT, AS REQUIRED BY THE STATE OF OHIO, YOU HAVE RECEIVED THE CONSUMER GUIDE TO AGENCY RELATIONSHIPS.



THE SHOPS AT HAWK'S LANDING

Jerome Township, Ohio

KEY	LEASED	NEGOTIATING
	AVAILABLE	NOT PART

UNIT	TENANT	SIZE (SQ. FT.)
1	Available	1.61 AC
2	Available	1.31 AC
3	Available	1.52 AC
4	Negotiating	±1.88 AC
5	Available	±1.09 AC
6	Negotiating	±1.64 AC

LEASING INFORMATION

DANIEL CLARK

Vice President & Manager, Columbus Office
daniel@goodmanrealestate.com

JOE BELINSKE

Sales Associate, Columbus Office
joe@goodmanrealestate.com

CLEVELAND

THE OFFICES OF LEGACY VILLAGE
25333 CEDAR ROAD, SUITE 305
CLEVELAND, OH 44124

COLUMBUS

389 E. LIVINGSTON AVENUE
COLUMBUS, OHIO 43215

P 216.381.8200

F 216.381.8211

WWW.GOODMANREALESTATE.COM

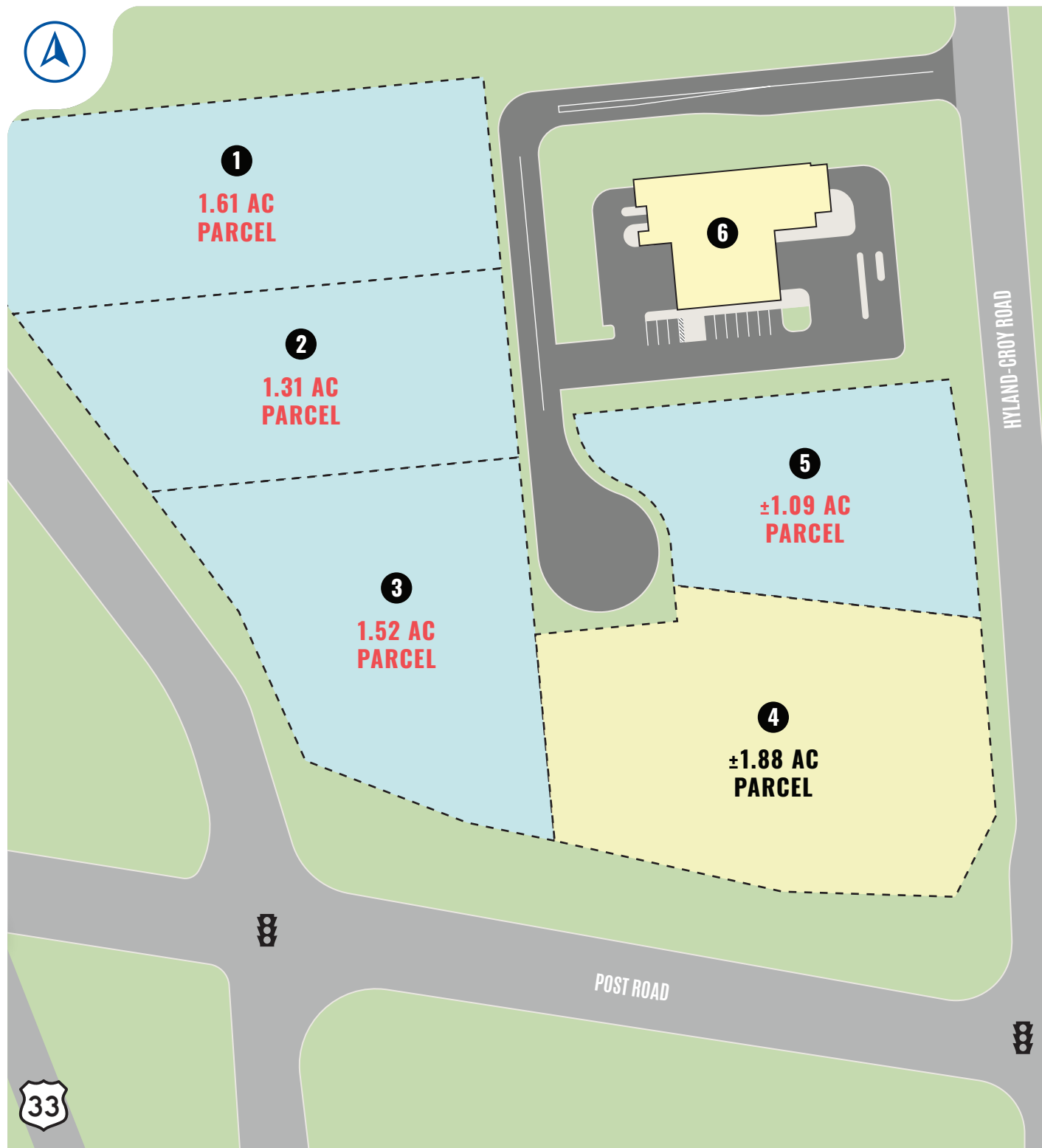

THE INFORMATION ABOVE HAS BEEN OBTAINED FROM SOURCES BELIEVED TO BE RELIABLE. GOODMAN REAL ESTATE SERVICES GROUP LLC AND ITS AGENTS, ASSOCIATES, AND EMPLOYEES MAKE NO GUARANTEE, WARRANTY OR REPRESENTATION ABOUT IT. ALL IMAGES CONTAINED HEREIN ARE THE PROPERTY OF GOODMAN REAL ESTATE SERVICES GROUP LLC AND SHALL NOT BE DUPLICATED OR REPRODUCED WITHOUT EXPRESS WRITTEN CONSENT OF GOODMAN REAL ESTATE SERVICES GROUP LLC. YOU ACKNOWLEDGE THAT, AS REQUIRED BY THE STATE OF OHIO, YOU HAVE RECEIVED THE CONSUMER GUIDE TO AGENCY RELATIONSHIPS.