



WWW.GOODMANREALESTATE.COM
216.381.8200

FORMER BANK OUTLOT THE SHOPPES AT WILLOUGHBY HILLS

Willoughby Hills, Ohio



HIGHLIGHTS

- **AVAILABLE:** Freestanding 4,531 SF bank building with three drive-thru lanes
- Located on Chardon Road in front of the Shoppes at Willoughby Hills
- Nearby retailers and restaurants include NEW Marc's, NEW Aldi, Milestone Athletic Club, Dollar Tree, NEW Zoom Express Car Wash, CVS, Serpentine Chevrolet, McDonald's, Subway, Dunkin', Eastside Volkswagen, NTB, and more

DEMOGRAPHICS

POPULATION	3 MILE	5 MILE	7 MILE
2029 Projection	77,099	187,753	295,465
2024 Estimate	78,599	192,278	302,514
INCOME	3 MILE	5 MILE	7 MILE
2024 Average	\$66,678	\$66,982	\$73,817
2024 Median	\$48,570	\$49,929	\$51,651
DAYTIME POPULATION	3 MILE	5 MILE	7 MILE
2024 Employees	28,027	63,813	95,138

LEASING INFORMATION
www.goodmanrealestate.com
216.381.8200

CLEVELAND THE OFFICES OF LEGACY VILLAGE
25333 CEDAR ROAD, SUITE 305
CLEVELAND, OH 44124

COLUMBUS 389 E. LIVINGSTON AVENUE
COLUMBUS, OHIO 43215

ZACK SOGOLOFF
Senior Vice President
zack@goodmanrealestate.com

SETH MARKS
Senior Director
seth@goodmanrealestate.com

THE INFORMATION ABOVE HAS BEEN OBTAINED FROM SOURCES BELIEVED TO BE RELIABLE. GOODMAN REAL ESTATE SERVICES GROUP LLC AND ITS AGENTS, ASSOCIATES, AND EMPLOYEES MAKE NO GUARANTEE, WARRANTY OR REPRESENTATION ABOUT IT. ALL IMAGES CONTAINED HEREIN ARE THE PROPERTY OF GOODMAN REAL ESTATE SERVICES GROUP LLC AND SHALL NOT BE DUPLICATED OR REPRODUCED WITHOUT EXPRESS WRITTEN CONSENT OF GOODMAN REAL ESTATE SERVICES GROUP LLC. YOU ACKNOWLEDGE THAT, AS REQUIRED BY THE STATE OF OHIO, YOU HAVE RECEIVED THE CONSUMER GUIDE TO AGENCY RELATIONSHIPS.



LEASING INFORMATION

www.goodmanrealestate.com

216.381.8200

ZACK SOGOLOFF

Senior Vice President
zack@goodmanrealestate.com

SETH MARKS

Senior Director
seth@goodmanrealestate.com

FORMER BANK OUTLOT

Willoughby Hills, Ohio



MAR 24



LEASING INFORMATION

www.goodmanrealestate.com

216.381.8200

ZACK SOGOLOFF

Senior Vice President
zack@goodmanrealestate.com

SETH MARKS

Senior Director
seth@goodmanrealestate.com

FORMER BANK OUTLOT

Willoughby Hills, Ohio





LEASING INFORMATION

www.goodmanrealestate.com

216.381.8200

ZACK SOGOLOFF

Senior Vice President
zack@goodmanrealestate.com

SETH MARKS

Senior Director
seth@goodmanrealestate.com

FORMER BANK BUILDING

Willoughby Hills, Ohio



Lease Outline Drawing

Shoppes at Willoughby Hills

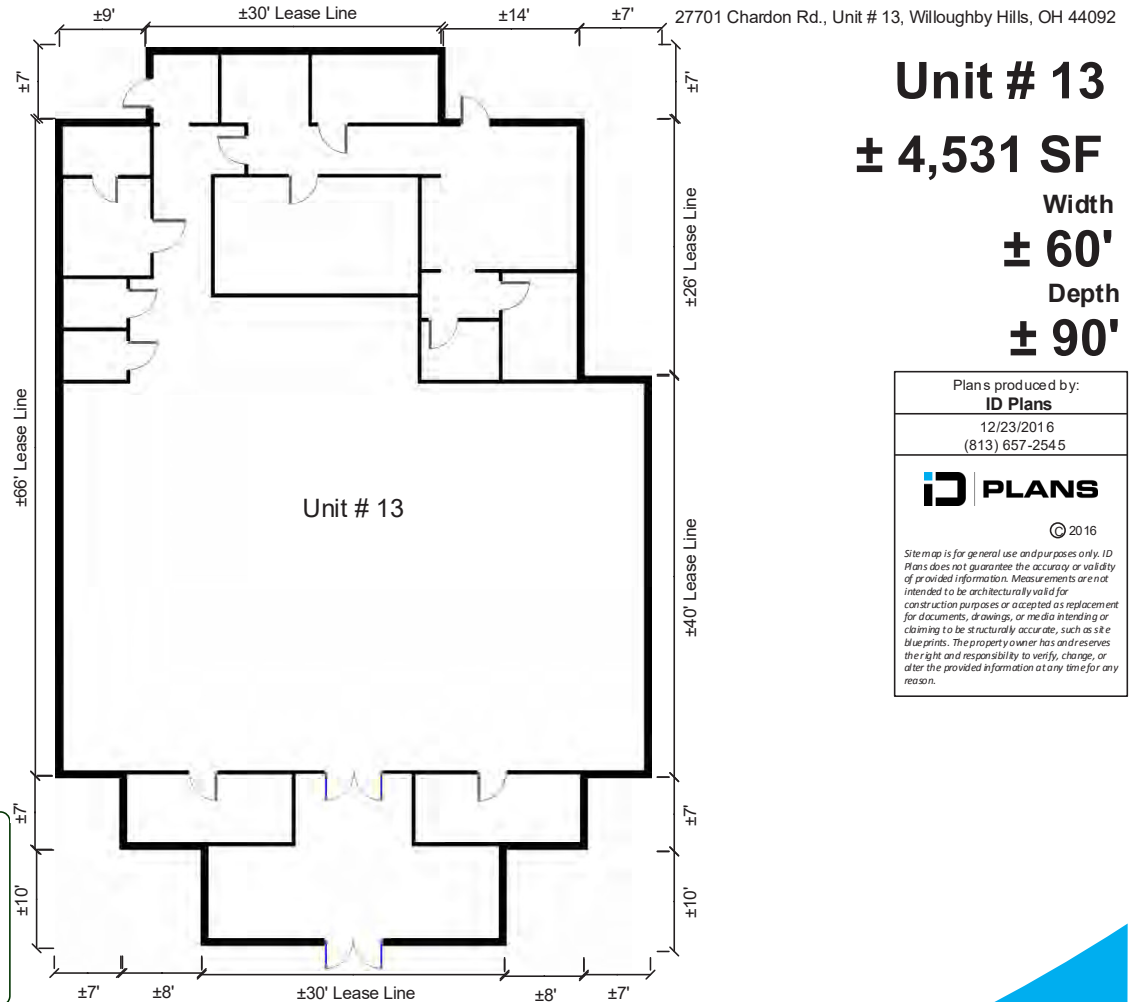

Unit # 13
± 4,531 SF
 Width
± 60'
 Depth
± 90'

Plans produced by:
ID Plans
 12/23/2016
 (813) 657-2545

ID PLANS
 © 2016

Site map is for general use and purposes only. ID Plans does not guarantee the accuracy or validity of provided information. Measurements are not intended to be architecturally valid for construction purposes or accepted as replacement for documents, drawings, or media intended or claiming to be structurally accurate, such as site blueprints. The property owner has and reserves the right and responsibility to verify, change, or alter the provided information at any time for any reason.

	Reference #	Meter #	Size
Electric		A12623189	
Gas		9592526	
Water		69175391	3/4"

HVAC Units & Information						
Unit #	Space #	Manufacturer	Model #	Tonnage	Serial #	Year
1	13	TRANE	4TEH3F60B1000AB	5	10214Y251V	2010
2	13	RESCO	FG3AAA060000AAAA	5	4094V17135	1994
3	13	CARRIER	40RR-012---550--	10	1694F92685	1994

Leasing Agent

Email: _____
 Office: _____
 Cell: _____