



WWW.GOODMANREALESTATE.COM  
216.381.8200

# RIDGE PARK SQUARE DENTAL CENTER

Brooklyn, Ohio



JUL 24

## HIGHLIGHTS

- **AVAILABLE:** 4,292 SF former dental center
- Built-out dental office with a full lab and surgical rooms
- Ridge Park Square is located on the northwest corner of the Interstate 480 and Ridge Road interchange
- Anchored by Lowe's, Marc's, Ashley, T.J.Maxx, Michaels, AMC, and Ross Dress for Less
- Excellent visibility and signage on Interstate 480, which sees over 120,000 vehicles daily

## DEMOGRAPHICS

POPULATION	3 MILE	5 MILE	7 MILE
2028 Projection	143,760	328,540	504,201
2023 Estimate	148,282	336,735	514,263
INCOME	3 MILE	5 MILE	7 MILE
2028 Average	\$57,853	\$63,514	\$68,994
2023 Median	\$45,709	\$48,499	\$51,251
DAYTIME POPULATION	3 MILE	5 MILE	7 MILE
2023 Employees	59,815	156,606	310,738

## LEASING INFORMATION

www.goodmanrealestate.com  
216.381.8200

### CLEVELAND

THE OFFICES OF LEGACY VILLAGE  
25333 CEDAR ROAD, SUITE 305  
CLEVELAND, OH 44124

### COLUMBUS

389 E. LIVINGSTON AVENUE  
COLUMBUS, OHIO 43215

## ZACK SOGOLOFF

Senior Vice President  
zack@goodmanrealestate.com

## SETH MARKS

Senior Director  
seth@goodmanrealestate.com





# LEASING INFORMATION

www.goodmanrealestate.com

216.381.8200

## ZACK SOGOLOFF

Senior Vice President  
zack@goodmanrealestate.com

## SETH MARKS

Senior Director  
seth@goodmanrealestate.com

# RIDGE PARK SQUARE DENTAL CENTER

Brooklyn, Ohio



JUL 24





## LEASING INFORMATION

[www.goodmanrealestate.com](http://www.goodmanrealestate.com)

216.381.8200

### ZACK SOGOLOFF

Senior Vice President  
[zack@goodmanrealestate.com](mailto:zack@goodmanrealestate.com)

### SETH MARKS

Senior Director  
[seth@goodmanrealestate.com](mailto:seth@goodmanrealestate.com)

# RIDGE PARK SQUARE DENTAL CENTER

Brooklyn, Ohio







## LEASING INFORMATION

www.goodmanrealestate.com

216.381.8200

**ZACK SOGOLOFF**

Senior Vice President  
zack@goodmanrealestate.com

**SETH MARKS**

Senior Director  
seth@goodmanrealestate.com

# RIDGE PARK SQUARE DENTAL CENTER

Brooklyn, Ohio



**128,247 VPD (23)**







# LEASING INFORMATION

www.goodmanrealestate.com

216.381.8200

## ZACK SOGOLOFF

Senior Vice President  
zack@goodmanrealestate.com

## SETH MARKS

Senior Director  
seth@goodmanrealestate.com

# RIDGE PARK SQUARE DENTAL CENTER

## Brooklyn, Ohio

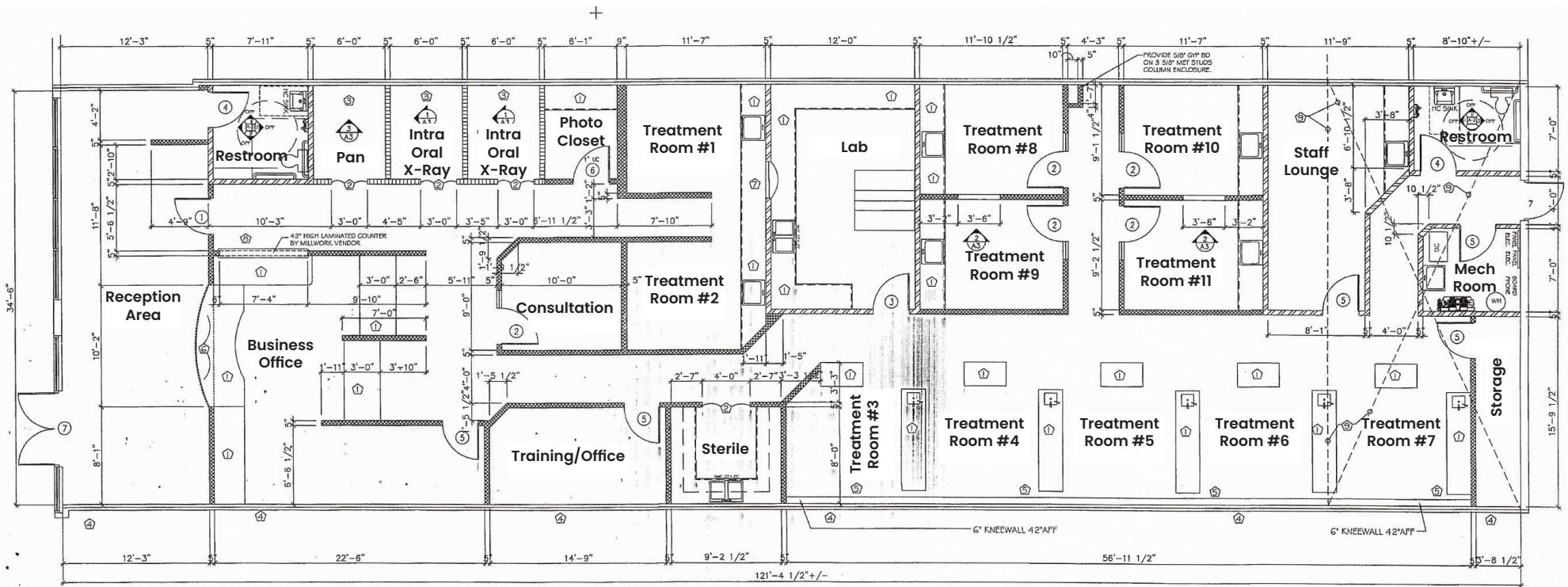

### FLOOR PLAN

3/16"=1'-0"

